

With this kit it is possible to place the blower of the kitchen hood to a remote position inside the house.

**Installation of the kit must be carried out by qualified staff, following all the rules given by the relevant authorities concerning the exhaust air ducting.**

**The manufacturer will not be liable for any damages resulting from incorrect or from improper installation.**

## **SAFETY RECOMMENDATIONS**

---

- **Do not connect the kit to exhaust ducts carrying combustion fumes (boilers, fire-places, etc.).**
- **Make sure that the mains voltage corresponds to that indicated on the rating plate inside the hood.**
- **Make sure that domestic power supply guarantees correct earthing.**
- **Once having carried out the electrical connection, the blower has to be connected to the mains through a double pole switch with 3 mm clearance between the contacts.**
- **It is necessary to unplug the blower from the mains supply before carrying out any cleaning or maintenance work.**
- **If the blower is used in conjunction with non-electrical appliances (e.g. gas burning appliances), a sufficient degree of aeration must be guaranteed in the room.**  
**A proper use without any risks is obtained when the maximum depression inside the room doesn't exceed 0,04 mbar; in this way a possible return of the combustion gas in the room can be avoided.**
- **It is necessary to provide an adequate thermal isolation in case the blower is placed in particularly cold rooms.**

## DISCONNECTING THE SUCTION UNIT

- Remove the grease filters from the hood.
- If the hood is of the recirculation type, remove the odour filters:
- For hoods with a flat odour filter (**A**): release the fixing hooks;

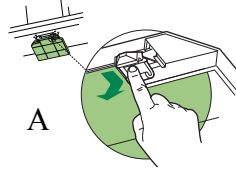

- For hoods with a bayonet odour filter (**B**): turn as indicated and extract.

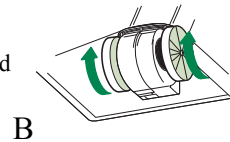

- Disconnect the power connector **Ca** and the control and lighting connector **Cmd** on the sides of the unit.
- Turn the levers **Lb** or unscrew the plugs **Vb** locking the suction unit.
- Pull the suction unit forwards so that it unhooks from the support pins, and remove it downwards through the air outlet.

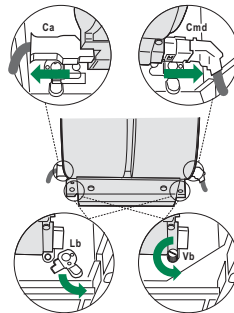

# COMPONENTS

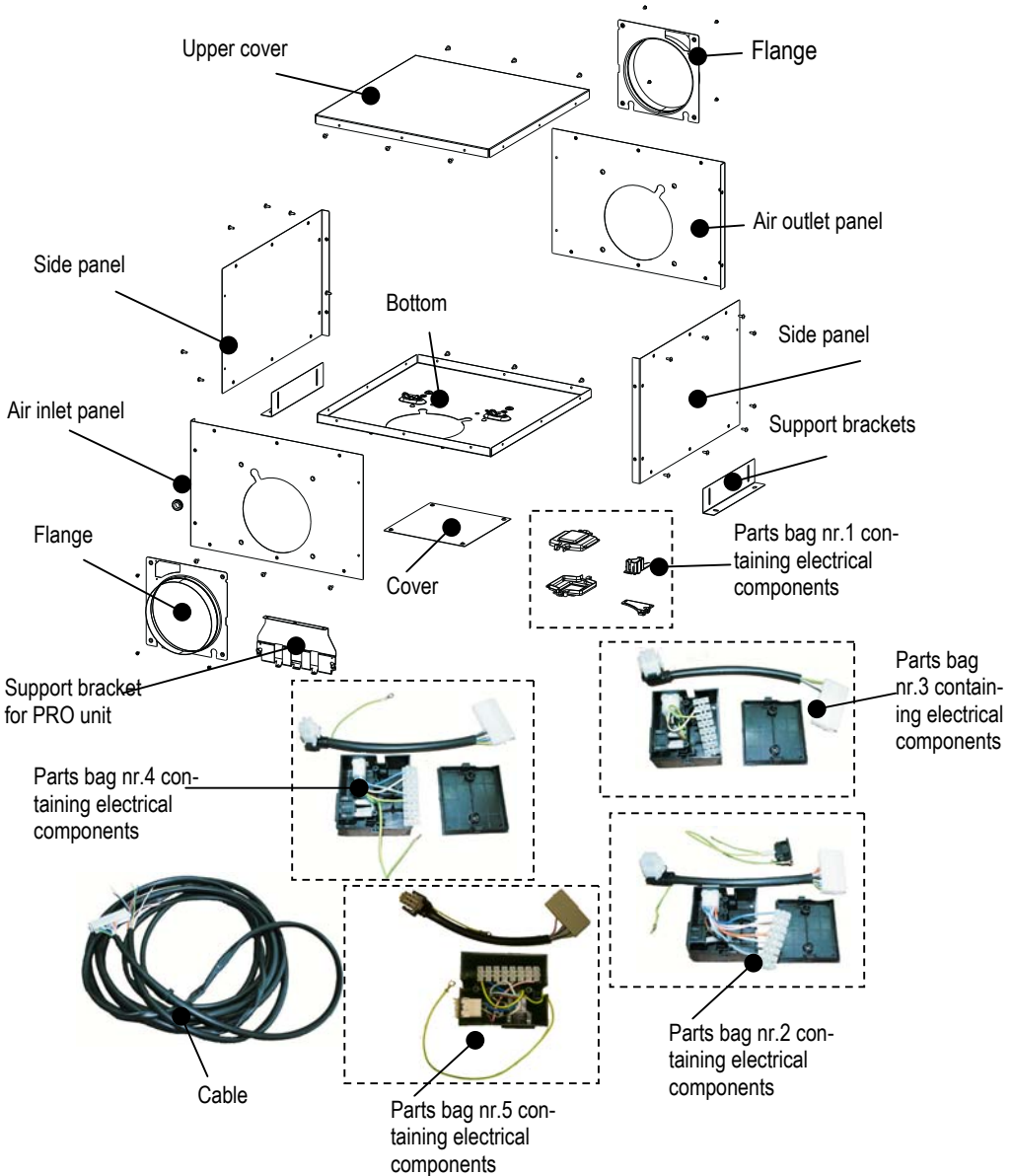

## Assembling of the remote blower casing

---

Proceed as shown in the picture when assembling the casing components.

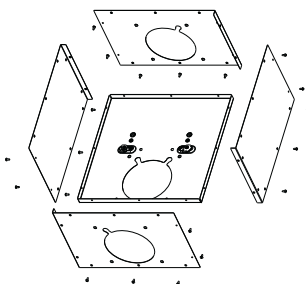

Mount the flanges and the air outlet cover.

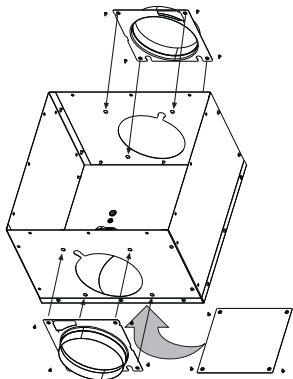

# ASSEMBLING OF THE MOTOR UNIT

Before placing the motor unit inside the casing it is necessary to identify the motor type. The choice of right electrical components to be used and preparation of the motor for final installation depend on the motor type.

## MOTOR TYPES

PRO motor	Hi-Lo motor	D09 Motor
 A silver-colored motor unit with a circular front grille and a top-mounted cap.	 A dark-colored motor unit with a circular front grille and a top-mounted cap.	 A dark-colored motor unit with a circular front grille and a top-mounted cap.

## PLACING OF THE MOTOR

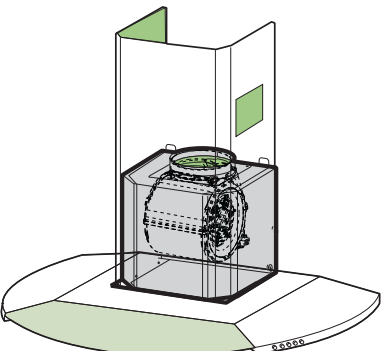
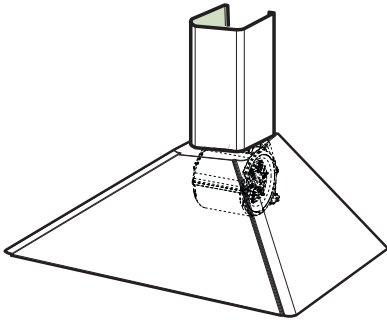
Hood equipped with Easy Cube	Hood without Easy Cube
 A technical drawing showing a motor unit being placed into a square Easy Cube, which is mounted on a circular base. The Easy Cube is partially open, and the motor is being inserted from the top.	 A technical drawing showing a motor unit being placed into a hood structure. The hood has a square top section and a conical base. The motor is being inserted from the top of the square section.

## DRILLING THE EASY CUBE -UNIT

- If the hood is equipped with a motor casing such as Easy Cube then prepare the hole as shown in the picture.



## PREPARING OF THE MOTOR

If the hood is equipped with a motor like Hi-Lo inside the Easy Cube it is necessary to remove the metal bracket placed behind the motor.

If the hood is equipped with a motor like PRO inside the Easy Cube it is necessary to replace the metal bracket behind the motor with the one supplied (parts bag nr. 4).



## CHOICE OF THE PARTS BAG CONTAINING ELECTRICAL COMPONENTS

It is necessary to use parts bag nr. 1 and 4 in case of motor unit like PRO.

It is necessary to use parts bag nr. 1 and 5 in case of motor unit like D09.

It is necessary to use parts bag nr. 1 and 2 in case of motors like Hi-Lo, with the exception of hoods having the following controls:

Vario C controls	Vario S controls

In case of these control systems parts bag nr. 1 and 3 are needed.

## FIXING OF THE MOTOR

Place the motor inside the casing and block it by turning the levers on both sides of the motor.

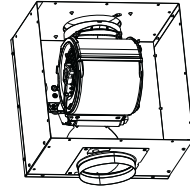

## CHOISE OF THE BLOWER DIRECTION

As shown in the picture, the blower can be directed in three different positions.

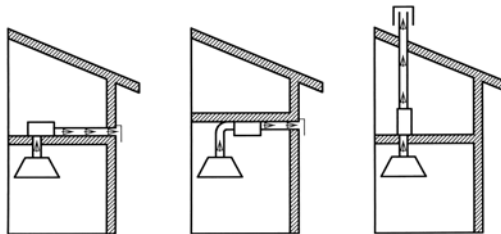

Basing on the chosen direction it is necessary to change position of the air inlet flange with the cover.

**In case the hood has to be installed it is advisable to follow the instructions this regarding supplied with the hood.**

**Before installing the hood definitively the junction box for electrical connection, contained in the parts bag, has to be fixed inside the hood. If the hood is equipped with Easy Cube it is advisable to fix the junction box using the two earlier drilled holes.**

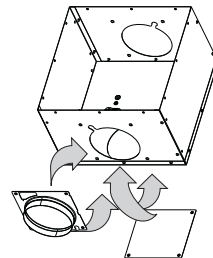

**Otherwise it is necessary to prepare a hole at the rear part of the hood and place the junction box in that position considering that it has to be easily reached in case of possible service interventions. Fixing of the box has to be carried out from the outside of the hood.**

The blower has to be connected to the hood and to the external air outlet with  $\varnothing$  150 mm tubes.

## FIXING OF REMOTE BLOWER

---

The fixing material supplied with this kit is suitable for wall fixing. In case the surface is other than wall it is necessary that the installer uses other material suitable for that purpose.

Basing on the chosen air outlet direction remove the screws from the holes and together with the wall fixing brackets place them again in their seats on the blower casing.

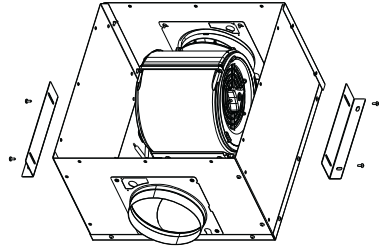

Mark the hole dots on the fixing surface.

Use a  $\varnothing$  8 mm drill.

Insert the raw plugs (supplied with the kit).

Fix the blower to the wall using the screws supplied with the kit; it is possible to correct the levelling of the blower by slightly moving it within the bracket slots.

## ELECTRICAL CONNECTION

---

A 7 m long cable, to be used for the connection between the blower and the hood, is supplied

Insert the cable in the grommet supplied with the kit. Place the grommet in its seat and extend the cable until it reaches the hood.

Replace the grommet of the hood mains cable with the grommet supplied with the blower kit. The one supplied with the kit has two holes; the first for the passage of the hood mains cable and the second for the passage of the remote blower connection cable.

Take the short cable with 12-position connector from the parts bag and connect it to the connection cable and consequently to the motor.

At this point it is advisable to verify the length of the cable necessary for the connection. The exceeding part can be cut.





In case the material of the parts bag nr.2 and nr.5 is used, it is necessary to verify that the connector for the mains cable assembled to the junction box is identical to that of the mains cable of the hood. In case it is not identical it is necessary to replace the connector of the junction box with the one contained in the parts bag and to fix the yellow/green wire to the terminal board.

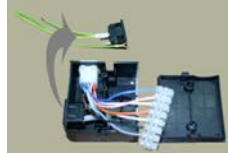

Connect the wires of the blower cable to the terminal board of the junction box respecting the order of colours and the number of wires. The excess of wires can be eliminated or connect in to the terminal board where there aren't wires.



In presence of a yellow/green wire this has to be fixed to the earthing terminal of the hood. For what concerns the yellow/green wire of the remote blower it is necessary to fix it to the earthing terminal of the remote blower casing.

Place the terminal board to the proper seat inside the junction box. Put the cables in order in their seats on both sides of the junction box. Close the junction box with the cover and the screws supplied with the kit.

Connect the mains supply connector **Ca** and the one for the hood controls and lighting system **Cmd** to the junction box.



Place the cover of the casing making sure that the holes are coinciding to each other. Fix the cover with the screws supplied with the kit.

