

ELECTRONIC NO-FROST REFRIGERATOR

Instruction booklet

Index

BEFORE USING THE APPLIANCE	2
Safety Instructions	2
Recommendations	3
Installation and Switching On The Appliance	4
Before Switching On	4
THE VARIOUS FUNCTION AND POSSIBILITIES	5
Control Panel	5
Switching on the appliance	6
Mode Button (MODE)	6
Super Freeze Mode	6
Super Cool Mode	7
Turbo Mode	8
Holiday Mode	8
Economy Mode (ECO)	8
Screen Saver Mode	9
No light Mode	9
Door open alarm Function	9
Freezer compartment temperature adjustment	10
Cooler compartment temperature adjustment	11
Warnings about temperature settings	11
Accessories	12
Making Ice Cubes	12
Fast Freezing Shelf	12
Chiller Shelves	12
Drawer	13
Wine Rack	13
Crisper and Crisper Shelf	13
Sliding Compartment	14
Fresh Dial	14
REMOVING THE CRISPER COVER	15
ARRANGING FOOD IN THE APPLIANCE	16
Refrigerator Compartment	16
Freezer Compartment	16
CLEANING AND MAINTENANCE	17
Defrosting	17
Replacing The Refrigerator and Freezer Light Bulb	18

TRANSPORTATION AND CHANGING OF INSTALLATION POSITION	18
Changing of Door Opening Direction	18
BEFORE CALLING YOUR AFTER SALES SERVICE	19
THE PARTS OF THE APPLIANCE AND THE COMPARTMENTS	22

PART- 1. BEFORE USING THE APPLIANCE

Safety Instructions

- If the model contains R600a-see name plate under refrigerant (the coolant isobutane), natural gas that, is very environmentally friendly but also combustible. When transporting and installing the unit care must be taken to ensure that none of the refrigeration circuit components become damaged. In the event of damage avoid naked flames or ignition sources and ventilate the room in which the unit is placed for a few minutes.

Warning: *Keep ventilation openings in appliance enclosure or in structure for building in, clear of obstruction.*

- Do not use mechanical devices or other artificial means to accelerate the defrosting process.
- Do not use electrical appliances in the refrigerator or freezer compartment of the appliance.
- If this appliance is to replace an old refrigerator with a lock; break or remove the lock as a safety measure before storing it, to protect children while playing might lock themselves inside.
- Old refrigerators and freezers contain insulation gases and refrigerant, which must be disposed of properly. Entrust the disposal of a scrap unit categorically to competence of your local waste disposal service and contact your local authority or your dealer if you have any questions. Please ensure that the pipe of work of your refrigerating unit does not get damaged prior to being picked-up by the relevant waste disposal service.

IMPORTANT NOTE:

Please read this booklet before installing and switching on this appliance. The manufacturer assumes no responsibility for incorrect installation and usage as described in this booklet.

Recommendations

Warning: Do not use mechanical devices or other artificial means to accelerate the defrosting process. Do not use electrical appliances in the food storage of the appliance. Keep the appliance ventilation openings free. Do not damage the refrigerator's refrigerant circuit.

- Do not use adopters or shunts which could cause overheating or burning.
- Do not plug old, warped power supply cables.
- Do not twist and bend the cables.

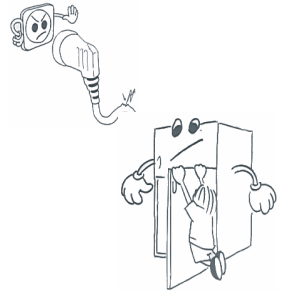

- Do not allow children to play with the appliance. Children must NEVER sit on drawers/shelves or hang from the door.
- Do not plug the power supply with wet hands.
- Do not place containers (glass bottles or tin containers) of liquids into the freezer especially gassy liquids as they could cause the container to burst during freezing.
- Bottles, which contain a high percentage of alcohol must be sealed well and placed vertically in the refrigerator.
- Do not touch the cooling surfaces, especially with wet hands as you could be burnt or hurt.
- Do not eat ice, which have just been removed from the freezer.
- The appliance is not intended for use by people (including children) with reduced physical, sensory or mental capabilities, or lack of experience and knowledge, unless they have been given supervision or instruction concerning use of the appliance by a person responsible for their safety. Children should be supervised to ensure that they don't play with the appliance.
- If the supply cord is damaged it must be replaced by the manufacturer or service agent or appointed person.

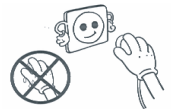

Installation and Switching On The Appliance

- This appliance is connecting to 220-240V and 50 Hz.
- You can offer help from the service to install and switching on the appliance without any cost.
- Before making the connection to the power supply, ensure that the voltage on the nameplate corresponds to the voltage of electrical system in your home.
- If the socket does not match the refrigerator plug, replace the plug with a suitable one (at least 16 A)
- Insert the plug into a socket with an efficient ground connection. If the socket has no ground contact, we suggest you call an electrician for assistance.
- **Manufacturer is not responsible for failure to complete the ground connection as described in this booklet.**
- Do not place the appliance in direct sunlight.
- Do not use in open air and shall not be exposed to the rain.
- Place the refrigerator far from heat sources and in a well-ventilated position. The refrigerator should be at least 50 cm from radiators, gas or coal stoves and 5 cm far from electrical stoves.
- Keep the top free for at least 15 cm.
- Do not place heavy and lots of things on the appliance.
- If the appliance is installed next to another refrigerator or freezer, observe a minimum distance of 2 cm to prevent condensation.
- The appliance must be stand firmly and level on the floor Use the two front levelling-feet to compensate for an even floor.
- Install the distance adjustment plastic (the part with black vanes at the rear) by turning it 90° to prevent the condenser from touching the wall.
- In order to have air circulation under the appliance, the space under the appliance must be open. Don't close it with carpet , etc.
- The outside of the appliance and the accessories inside should be cleaned with a solution of water and liquid soap; the inside of the appliance with sodium bicarbonate dissolved in lukewarm water. After drying replace all the accessories.

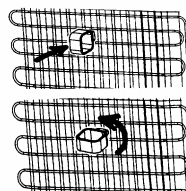

Before Switching On

- Wait after 3 hours before plugging the appliance in to the main power to ensure proper performance.
- There can be an odour when you first switch on the appliance. It will disappear after the appliance starts to cool.

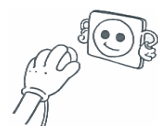

PART-2. THE VARIOUS FUNCTION AND POSSIBILITIES

Control Panel

Freezer Compartment Temperature Bars

When -16°C is active, 1 bar lights; when -18°C is active 2 bars light; when -20°C is active 3 bars light; when -22°C is active 4 bars light; when -24°C is active 5 bars light.

Cooler Compartment Temperature Bars

When +8 is active, 1 bar lights; when +6 is active , 2 bars light; when +4 is active, 3 bars light; when +2 is active , 4 bars light.

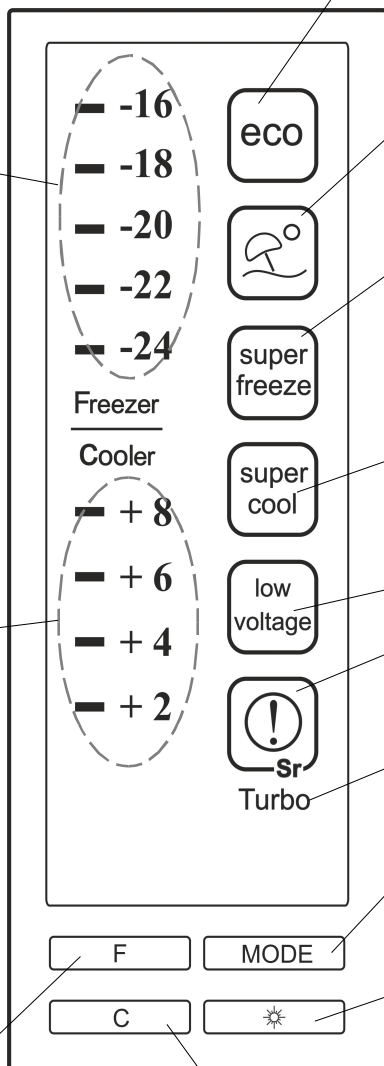

When this mode is selected, your appliance works in economical mode. During mode economy symbol lights, cooler part shows +4°C, freezer part shows -18°C.

When this mode is selected, your appliance works in Holiday Mode. During mode only holiday symbol lights.

When this mode is selected, Super Freeze mode is engaged. During mode Super Freeze symbol light, Freezer bars don't light. Cooler part shows setting temperature and bars light according to temperature value.

When this mode is selected, Super Cool mode is engaged. During mode super cool symbol lights, Cooler bars don't light. Freezer part shows setting temperature and bars show setting temperature.

This symbol lights in low-voltage

When your appliance has a failure, this symbol lights.

Turbo symbol lights when both Super cooling and super freezing symbol is selected

If user goes on pushing Mode Button, in a sequence, Holiday, Fast Freezing, Super Cooling and Turbo Modes can be selected.

When you press and hold screen saving button for 3 seconds, this mode is activated. While this mode is activated, if no key is pressed for 5 seconds, lights of the control panel go off.

With each pushing on this button, the temperature decreases of 2 degrees.

(-16°C, -18°C, -20°C, -22°C, -24°C)

With each pushing on this button, the temperature decreases of 2 degrees.

(+8°C, +6°C, +4°C, +2°C)

Switching on the appliance

After the equipment is attached to the wall outlet, all symbols appear on the screen for 2 seconds and then the initial temperature value of -18°C is displayed in the deep freezer setting indicator and the initial temperature value of $+4^{\circ}\text{C}$ is displayed in the refrigerator setting indicator.

Mode Button (MODE)

- Press mode button once.
- When you press mode button first, economy symbol will blink and in 1 second if none of button is pushed, symbol will blink 3 times and sound beep.
- If user goes on pushing mode button, in a sequence, holiday, fast freezing, super cooling and turbo modes can be selected. There will be no mode selected in 6th pushing of mode button.
- When the wanted symbol is in the screen, do not push any button in 1 second. Symbol will blink 3 times and you will sound beep.
- With the sound of beep, wanted mode will be selected and will be seen in the screen.

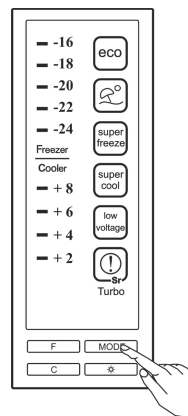

Super Freeze Mode

When will apply ;

- To freeze lots of food that cannot fit into "Fast Freezing Shelf".
- To freeze prepared foods
- To freeze faster
- To conceal fresh foods and vegetables

How to use ;

- Press mode button until Super Freezing symbol will light.
- Symbol will blink 3 times and a beep of confirmation will sound if user does not push any button within 1 seconds.
- During this mode, 'super freeze' symbol will lighten. Freezer
- Bars will not lighten. Cooler part will show setting temperature and bars will lighten according to temperature value.
- 3 hours after being activated, your refrigerator starts giving signals. This signal tells that the quickfreezer compartment is ready for the foods to be placed in it. Your refrigerator will give intermittent beep sounds for 1 minute in every 5 minutes; provided that the doors are not opened, this signal giving will last 1 hour. When this sound is heard, foods to be frozen must be placed away from the already frozen ones. When

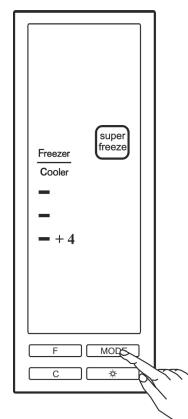

the door of the freezer or cooler is opened, this signal stops. When your foods are cooled enough, your refrigerator will automatically go out of the quick freezing mode. After a period of maximum 24 hours after the function is activated, the freezing process will be completed.

- During this mode , cooler temperature adjusting can be done.
- Freezer temperature adjusting can be done but will not be active until super freezing finishes.
- Holiday and Economy modes will not work until Super Freezing mode finishes.
- Mode will be cancelled if selected super freezing mode symbol again.

Note: “SUPER FREEZE” will be cancelled automatically after 24 hour or when freezer Sensor $<-32^{\circ}\text{C}$.

Super Cool Mode

When will apply;

- To cool the prepared foods.
- To cool and conceal a lots of food in refrigerator compartment.
- To cool the drinks more quickly.

How to use;

- Press mod button until super cooling symbol will light.
- Symbol will blink 3 times and a beep of confirmation will sound if user does not push any button within 1 seconds.
- ‘Super Cool’ symbol will light during this mode. Cooler Bars will not light. Freezer part will show setting temperature and bars will show setting temperature.
- Holiday and Economy modes will not work until super cooling mode finishes.
- Super Freezing and Freezer temperature adjusting can be enabled.
- Refrigerator temperature adjusting can be done but will not be active until super cooling finishes.
- Mode will be cancelled if selected super cooling mode symbol again.

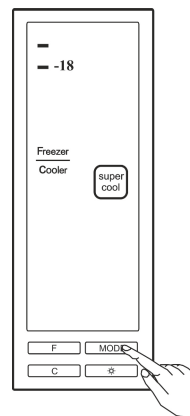

Note: When the sensor of the refrigerator compartment reaches -4°C or the function stops automatically after 8 hours. The reason of this time period was restricted as 8 hours is to prevent food freezing risks which can be occurred by powerful cooling attribute.

Turbo Mode

When will apply;

- Turbo symbol will light when both Super cooling and super freezing symbol is selected

How to use ;

- Press Mode button until Turbo symbol will light. Symbol will blink 3 times and a beep of confirmation will sound if user does not push any button within 1 seconds.
- When "Turbo" mode is on, 'super cool' and 'super freeze' symbol will light.
- Freezer and cooler bar graphic lights will be off.
- Holiday and Economy modes will not work until "Turbo" mode finishes.
- Freezer and cooler temperature's adjusting can be done but will not be active until turbo mode is deactivated.
- Mode will be cancelled if selected turbo mode symbol again

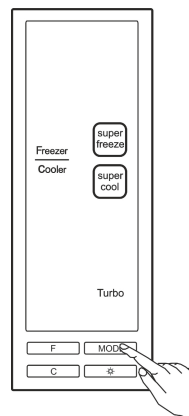

Holiday Mode

When will apply;

- If you will go to holiday and you want to load out the cooler part, you can use holiday mode.

How to use ;

- Press mod button until Holiday symbol will light.
- Symbol will blink 3 times and a beep of confirmation will sound if user does not push any button within 1 seconds.
- Freezer compartment will go on working with the set value defined on the control circuit during the holiday mode.
- During this mode, holiday symbol will light.
- Cooler temperature segment and freezer temperature segment and bar graphic lights will be off.
- Mode will be cancelled if selected holiday symbol again.
- Appliance will go on to work with previous manually adjusted values. If no temperature values have been adjusted manually, it will go on with initial values (Freezer Compartment -18°C and Refrigerator Compartment +4°C)

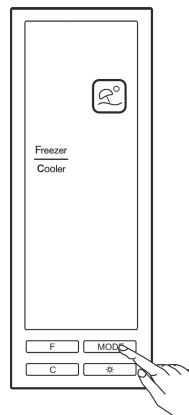

Economy Mode (ECO)

When will apply;

- When you want to work your appliance in economical mode.
- If you want to use at a set value is defined on the control circuit.
- Both compartments will work in the normal regulation with the set values

How to use ;

- Press Mode button until Economy symbol will light.
- Symbol will blink 3 times and a beep of confirmation will sound if user does not push any button within 1 seconds.
- During mode economy symbol will light, cooler part will show +4°C, freezer part will show -18°C.
- The other modes will not work till economy mode finishes.
- Mode can be cancelled by selecting symbol again.

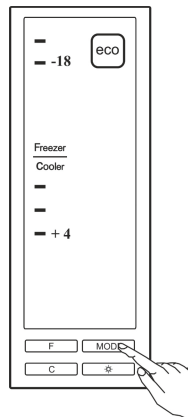

Screen Saver Mode

When will apply;

- If you do not want the control panel lights to be on and consume energy unnecessarily while you have not made any changes in your settings, you may activate this mode.

How to use ;

- When you press and hold screen saving button for 3 seconds, this mode will be activated.
- While this mode is activated, if no key is pressed for 5 seconds, lights of the control panel will go off.
- If you press on any key when the control panel's light's are off, current settings appear on the display to let you make any change you wish. If you do not cancel the screen saving mode or press any key for 5 seconds, control panel will dim again.
- To cancel the screen saving mode, press any button and hold the screen saving mode button again for 3 seconds.

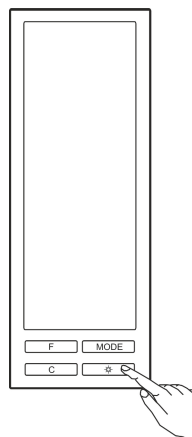

No light Mode

When will apply;

- If you want to disable lamps for both of compartments, you can choose this mode. Lamps will not light till mode is cancelled.

Setting This Mode;

- Push both cooler and freezer button at the same time, open and close freezer door 3 times.

Cancelling This Mode;

- Function can be cancelled by the same way or after 24 hours appliance will directly cancel it.

Door open alarm Function

If cooler or freezer door is opened more than 2 minutes , appliance sounds 'beep beep'.

Freezer compartment temperature adjustment

- At first the freezer display will show -18°C.
- Press once "F" button.
- The first pushing of freezer button, user will see -16°C and bar which is near -16°C will light.
- With each pushing on this button, the temperature decreases of 2 degrees. (-16°C, -18°C, -20°C, -22°C, -24°C) Number segment and bar will blink 3 times and a beep of confirmation will sound.
- When -16°C is active, 1 bar will light; when -18°C active 2 bars will light; when -20°C is active 3 bars will light; when -22°C is active 4 bars will light; when -24°C is active 5 bars will light.
- If appliance was set to holiday, super freeze, super cool economy mode or turbo mode before temp. Adjusting, appliance will go on to work in previous mode. When previous mode is cancelled / finished manually or automatically appliance will start to work in adjusted values.

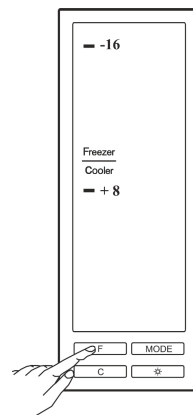

Note**: If Ambient sensor is > 38°C then user will not be able to adjust freezer Compartment's temp. to -22°C and -24°C. Then only -16°C, -18°C, -20°C will be available.

Recommended Settings For Freezer Compartment Temperature

Temperature Bar	When to use it?	Freezer Cabinet Inside Temperature
1 Bar	For little amount stoking	-16°C
2 Bars or 3 Bars	Normal stoking	-18°C or -20°C
4 Bars or 5 Bars	For lots of food stocking	-22°C or -24°C

Cooler compartment temperature adjustment

- At first the cooler part will show +4°C.
- Press once “C” button.
- The first pushing of cooler button, user will see +8°C and bar which is near +8°C will light.
- With each pushing on this button, the temperature decreases of 2 degrees. (+8°C, +6°C, +4°C, +2°C) Number segment and bar will blink 3 times and a beep of confirmation will sound.
- When number segment is +2°C. If you push refrigerator button, the number segment will go on from +8°C. When +8 is active, 1 bar will light; when +6 is active, 2 bars will light; when +4 is active, 3 bars will light; when +2 is active, 4 bars will light.
- If appliance was set to holiday, super freeze, super cool, economy or turbo mode before temp. adjusting, appliance will go on to work in previous mode. When previous mode is cancelled / finished manually or automatically appliance will start to work in adjusted values.

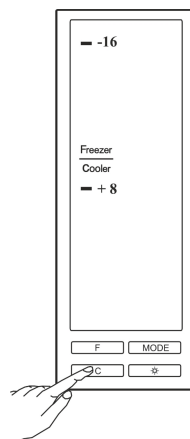

Recommended Settings For Cooler Compartment Temperature

Temperature Bar	When to use it?	Cooler Cabinet Inside Temperature
4 Bar	For lots of food stocking	+2°C
3 Bars or 2 Bars	Normal stoking	+4°C or +6°C
1 Bar	For little amount stoking	+8°C

Warnings about temperature settings

- Your temperature settings will still be valid during any power failure. Childproof function will be cancelled during power failures.
- Operating your refrigerator in ambient temperatures below 10oC is not recommended for its efficiency.
- The temperature settings should be made by taking into consideration how often the cooler and freezer door is opened and closed, and how much food is stored in it.
- Do not switch to another adjustment before completing a setting.
- Depending on the ambient temperature, your refrigerator must operate nonstop up to 24 hours in order to cool down completely after it is plugged in for the first time. During this period, do not open the doors of your refrigerator frequently and do not overfill.
- To prevent any damage on the compressor of your refrigerator when you want to restart your refrigerator after unplugging it or after a power failure is restored, there is a function which makes your refrigerator operate after a 5-minute delay. Your refrigerator will start operating normally after 5 minutes.

When you first switch on the appliance, for starting a suitable cooling, the appliance should work 24 hours continuously until it cools down to sufficient temperature. During this time do not open the door so often and do not place a lot of food inside the appliance.

Accessories

Making Ice Cubes

- Take out the ice making tray
- Fill the water in level of line.
- Place the ice making tray in its original position
- When ice cubes are formed, twist the lever to drop off ice cubes into the icebox.

Do not fill the icebox with water in order to make ice. It can be broken.



Fast Freezing Shelf

- Use the fast freezing shelf to freeze home cooking (and fresh foods which is wanted to freeze) more quickly because of the freezing room's greater freezing power.
- For opening the shelf pull the cover up, and slide it in to the shelf. You can close it in the same way

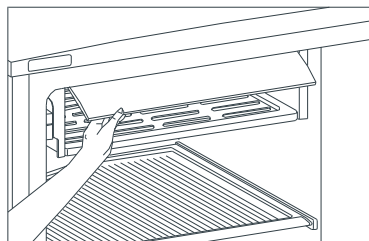

Note that; be sure that the cover of fast freezing shelf is closed before closing the compartment door. If not, it can not show its fast freezing power.

Chiller Shelves



Keeping food in the Chiller compartment instead of the freezer or refrigerator compartment allows food retain freshness and flavour longer, while preserving its fresh appearance. When chiller tray becomes dirty, remove it and wash it with water.

(Water freezes at 0°C, but foods containing salt or sugar freeze at temperature lower than that)

Normally people use the chiller compartment for raw fish, lightly pickled, rice, etc...

Do not put foods you want to freeze or ice trays in order to make ice.

Chiller shelf can be used as drawer if you want. For this, take the sliding part (cover) from open position to closed position.

Drawer

Drawer compartment has four pieces of drawer boxes in order to allow you to keep your foods and use these for breakfast easily.

For consumer's usage comfort and for the optimum of storage foods, you can easily move your drawer to right or to left direction.

Also you can easily pull the drawer compartment and take it out when needed.

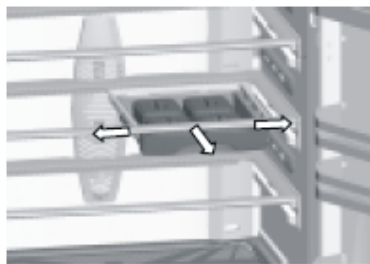

Note: In order to prevent drying of the foods and mixing of the smells you should close drawer boxes cover.

Wine Rack

It allows you to keep your bottles in horizontal position depending on your storage of refrigerator.

You can easily load the shelf under the wine rack by moving wine rack to right or to left.

If you do not need to this accessory please pull the glass shelf towards you and then take out wine rack from glass shelf by moving it to right or left. Please do not forget that you can fix it any of glass shelves in your product.

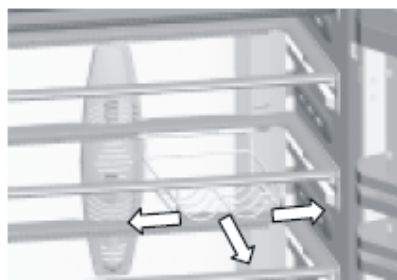

Note: to prevent of spilling the drinks in your bottle please keep your bottle lid as closed.

Crisper and Crisper Shelf

The crisper compartment absorbs and decomposes ethylene gas (*) emitted from fruits and vegetables with a "FILTER" in the crisper shelf, keeping fruits and vegetables fresh. The filter also eliminates unpleasant odours from inside the crisper, and control the excess water released by the vegetables, maintaining a high humidity environment inside the crisper. When the crisper shelf become dirty, remove the filter by taking out the filter cover and wash the crisper cover with water.

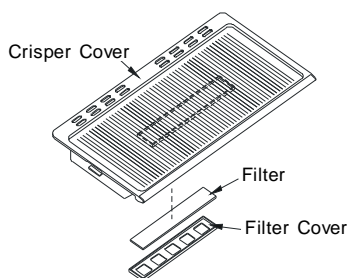

! Do not wash the "Humidity-Control Filter" with water.

(*)NOTE; Ethylene gas is a gas, produced from fruits and vegetables, which accelerates the ageing of fruits and vegetables. For example, spinach and broccoli turn to yellow colour easily in places where ethylene gas is abundant.

Sliding Compartment

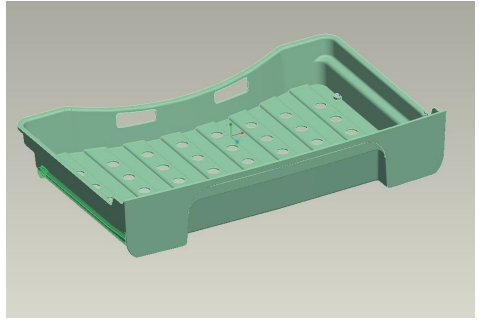
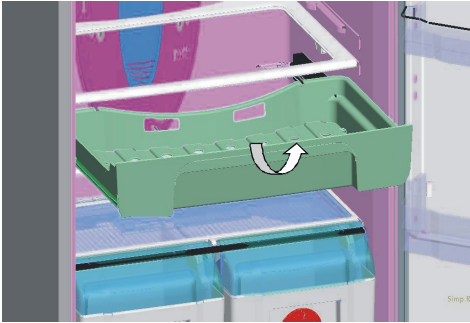

- The foods in the sliding compartment are retained in the same temperature as refrigerator compartments. So it should not be used as crisper or chiller shelves.
- The Sliding Compartment allows foods are maintained more regularly.

Removing The Sliding Compartment;

- Pull the compartment out as far as possible
- Pull the front of part up and out.

NOTE: Make the inverse of the same operation for the resetting the sliding compartment.

Fresh Dial

In case of the crisper is totally full, the fresh dial is located in front of crisper, should be opened. By means of this the air in the crisper and humidity rate will be controlled and endurance life will be increased.

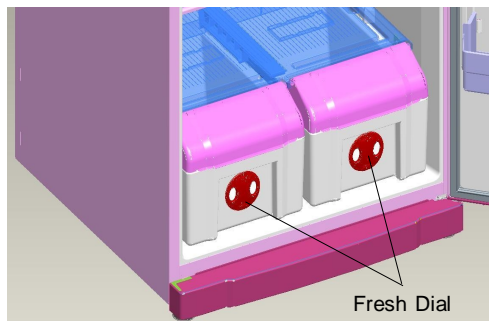

REMOVING THE CRISPER COVER

First Step: *Removing the crispers*

- Turn the front covers of crisper to the position which back side touch the crisper cover.
- Pull the crisper out as far as possible.
- Pull the front part up and out.

Note that; be sure that the front covers of crisper are closed before closing the refrigerator door.

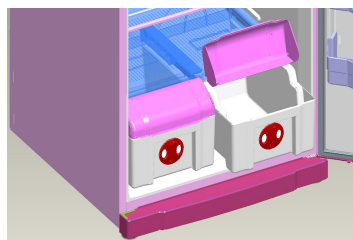

Second Step: *Taking out the partition crisper center between the crispers.*

- Turn the front covers of crisper to the position which back side touch the crisper cover.
- Bend the Partiton toward left from the bottom of the part.
- Take out the Partiton crisper.

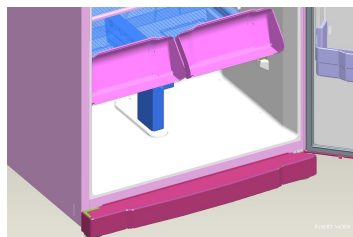

Third Step: *Taking out the crisper cover with front covers.*

- Pull the crisper cover when front covers of crisper are closed.
- Pull the crisper cover up and out.
- Don't split the front covers of crisper from the crisper cover. If not, the crisper cover can be broken.



Fourth Step: *Splitting the crisper cover from the front covers of crisper.*

- Bend the pim slot where is beside to crisper cover.
- Take out the front cover of crisper.

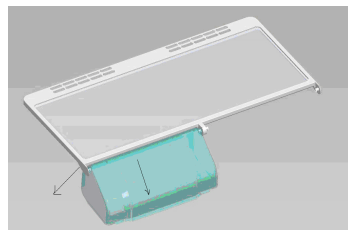

NOTE: *Make the inverse of the same operation for the resetting the crisper cover.*

All written and visual descriptions in the accessories may vary according to the appliance model.

PART- 3. ARRANGING FOOD IN THE APPLIANCE

Refrigerator Compartment

- To set the refrigerator compartment to 5 graphic bar will be enough for normal conditions.
- To reduce humidity and consequent increase of frost never place liquids in unsealed containers in the refrigerator.
- Never place warm food in the refrigerator. Warm food should be allowed to cool at room temperature and should be arranged to ensure adequate air circulation in the refrigerator compartment.
- Arrange the meat and cleaned fish (wrapped in packages or sheets of plastic) which you will use in 1-2 days.
- You can put the fruits and vegetables into crisper without packing.

Freezer Compartment

- To set the freezer compartment to 5 graphic bar will be enough for normal conditions.
- The use of freezer is, storing of deep-frozen or frozen foods for long periods of time and making ice cubes.
- Do not put fresh and warm foods to the freezer door shelves to be frozen. Only use for storage of frozen foods.
- Do not put fresh and warm food with frozen food side by side as it can thaw the frozen food.
- Use the fast freezing shelf to freeze home cooking (and the foods which is wanted to freeze) more quickly because of the freezing room's greater freezing power.
- While freezing fresh foods (i.e. meat, fish and mincemeat) divide them in parts you will use in one time.
- While freezing fresh foods ; Maximum amount of fresh food (in kg) that can be frozen in 24 hours is indicated on the appliance label.
- For optimum appliance performance to reach maximum freezing capacity , turn the freezer thermostat knob to position max 24 hours before placing fresh food in the freezer.
- After placing fresh food in the freezer ,24 hours on max position is generally sufficient, After 24 hours, don not need to set the freezer thermostat knob to position max.
- Attention; In order to save energy, When freezing small amounts of food, don not need to set the freezer thermostat knob to position max.
- **For storing the frozen foods;** the instructions shown on frozen food packages should always be followed carefully and if no information is provided food should not be stored for more than 3 months from the purchased date.
- **When buying frozen foods** ensure that these have been frozen at suitable temperatures and that the packing is intact.
- Frozen foods should be transported in appropriate containers to maintain the quality of the food and should be returned to the freezing surfaces of the unit in the shortest possible time.
- If a package of frozen food shows the sign of humidity and abnormal swelling it is probable that it has been previously stored at an unsuitable temperature and that the contents have deteriorated.
- **The storage life of frozen foods** depends on the room temperature, thermostat setting, how often the door is opened, the type of food and the length of time required to transport the product from the shop to your home. Always follow the instructions printed on the package and never exceed the maximum storage life indicated.

PART- 4. CLEANING AND MAINTENANCE

- Disconnect unit from the power supply before cleaning.
- Do not clean the appliance by pouring water.
- The refrigerator and freezer compartment should be cleaned periodically using a solution of bicarbonate of soda and lukewarm water
- Clean the accessories separately with soap and water. Do not clean them in the washing machine.
- Do not use abrasive products, detergents or soaps. After washing, rinse with clean water and dry carefully. When the cleaning operations have been completed reconnect the plug of the unit with dry hands.
- You should clean the condenser with broom at least once a year in order to provide energy saving and increase the productivity.

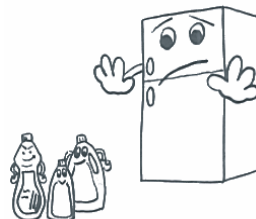
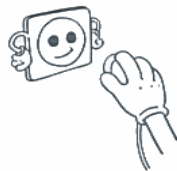

THE POWER SUPPLY MUST BE DISCONNECTED.

Defrosting

- Defrosting occurs fully automatically during operation; the defrost water is collected by the evaporating tray and evaporates automatically.

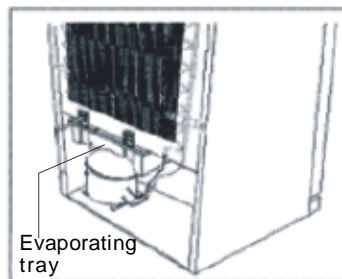

Replacing The Refrigerator and Freezer Light Bulb

1. Unplug the unit from the power supply,
2. Remove the refrigerator light cover with a minus screw driver, and take out the cover.(A)
3. Change the present light bulb with a new one of not more than 15 W.(B)
4. Replace the light cover and after waiting 5 minutes plug the unit.(C)

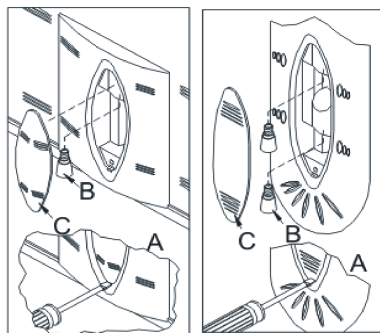

PART- 5. TRANSPORTATION AND CHANGING OF INSTALLATION POSITION

Transportation and Changing of Installation Position

- The original packages and foamed polystyrene (PS) can be concealed if required.
- In transportation the appliance should be tied with a wide stripe or a strong rope. The rules written on the corrugated box must be applied while transporting.
- Before transporting or changing old installation position, all the moving objects (i.e., shelves, crisper...) should be taken out or fixed with bands in order to prevent the shake.

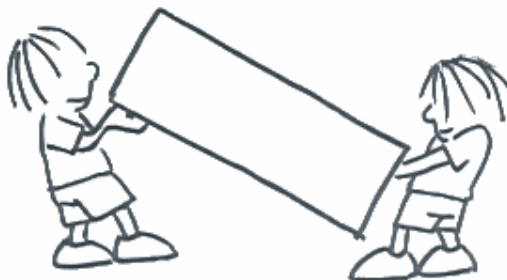

Changing of Door Opening Direction (For some models)

In case you need to change door-opening direction, please consult the domestic after sales service.

PART- 6. BEFORE CALLING YOUR AFTER SALES SERVICE

If your refrigerator is not working properly, it may be a minor problem, therefore check the following, before calling an electrician to save time and money.

ERROR TYPE	MEANING	WHY	WHAT TO DO
SR	Failure Warning	There is / are some part(s) Out of order or there is a failure in cooling process	Call Service after 1 hour when you see the failure
LOW VOLTAGE	Low Voltage	When the power supply gets lower than 170V the appliance gets to steady position.	This not a failure. This prevents any damages on the compressor. This warning will off after the voltage gets required level

What to do if your refrigerator does not operate;

Check that;

- There is no power ,
- The general switch in your home is disconnected ,
- The thermostat setting is on« 0 »position ,
- The socket is not sufficient. To check this, plug in another appliance that you know which is working into the same socket.

What to do if your refrigerator performs poorly;

Check that;

- You have not overloaded the appliance ,
- The doors are closed perfectly ,
- There is no dust on the condenser ,
- There is enough place at the rear and side walls.

If there is noise;

The cooling gas which circulates in the refrigerator circuit may make a slight noise (bubbling sound) even when the compressor is not running. Do not worry this is quite normal. If these sounds are different check that;

- The appliance is well levelled
- Nothing is touching the rear.
- The stuffs on the appliance are vibrating.

If your fridge is operating too loudly;

Normal Noises

Cracking (Ice cracking) Noise:

- During automatic defrosting.
- When the appliance is cooled or warmed (due to expansion of appliance material).

Short cracking

- Heard when the thermostat switches the compressor on/off.

Compressor noise

- Normal motor noise. This noise means that the compressor operates normally. Compressor may cause more noise for a short time when it is activated.

Bubbling noise and splash:

- This noise is caused by the flow of the refrigerant in the tubes of the system.

Water flow noise:

- Normal flow noise of water flowing to the evaporation container during defrosting. This noise can be heard during defrosting.

Air Blow Noise:

- Normal fan noise. This noise can be heard in No-Frost fridge during normal operation of the system due to the circulation of air.

If the edges of fridge cabinet that the door joint contact are warm;

- Especially in summer (hot weather), the surfaces that the joint contact may get warmer during the operation of the compressor, this is normal.

If humidity builds up inside the fridge;

- Are all food packed properly? Are the containers dried before placing them in the fridge?
- Are the fridge doors opened frequently? Humidity of the room gets in the fridge when the doors are opened. Humidity build up will be faster when you open the doors more frequently, especially if the humidity of the room is high.
- Building up of water drops on the rear wall after automatic defrosting is normal. (in Static Models)

If the doors are not opened and closed properly;

- Do the food packages prevent closing of the door?
- Are the door compartments, shelves and drawers placed properly?
- Are door joints broken or torn?
- Is your fridge on a level surface?

If your fridge is not cooling enough;

Your fridge is designed to operate in the ambient temperature intervals stated in the standards, according to the climate class stated in the information label. We do not recommend operating your fridge out of stated temperatures value limits in terms of cooling effectiveness.

<i>Climate Class</i>	<i>Ambient Temperature (°C)</i>
T	Between 16 and 43 (°C)
ST	Between 16 and 38 (°C)
N	Between 16 and 32 (°C)
SN	Between 10 and 32 (°C)

Recommendations

- In order to increase space and improve the appearance, the « cooling section » is positioned inside the back wall of the refrigerator compartment. When the appliance is running, this wall is covered with frost or water drops, according to whether the compressor is running or not. Do not worry. This is quite normal. The appliance should be defrosted only if an excessively thick layer forms on the wall.
- If the appliance is not used for long time (for example during the summer holidays) set the thermostat knob to « 0 » position. Defrost and clean the refrigerator leaving the door open to prevent the formation of mildew and smell.

Conformity Information

- Tropical Class is defined for the environment temperatures between 16°C and 43°C in accordance with the TS EN ISO 15502 Standards.
- The appliance is designed in compliance with the EN15502, IEC60335-1 / IEC60335-2-24, 2004/108/EC standards.
- The appliance complies with the “EEE” Regulation.

PART- 7.

THE PARTS OF THE APPLIANCE AND THE COMPARTMENTS

- 1- Fast Freezing shelf
- 2- Ice tray
- 3- Ice box
- 4- Freezer lamb box / cover
- 5- Freezer shelf
- 6- Freezer compartment
- 7- Chiller shelves
- 8- Refrigerator compartment
- 9- Refrigerator shelves
- 10- Refrigerator lamb box / cover
- 11- Sliding compartment
- 12- Crisper cover
- 13- Crisper front cover
- 14- Crisper
- 15- Fresh dial
- 16- Kick plate
- 17- Levelling feet
- 18- Bottom shelf
- 19- Floating shelf
- 20- Aroma box
- 21- Top shelf
- 22- Top shelf cover
- 23- Refrigerator lamb button
- 24- Freezer door shelf
- 25- Freezer lamb button

This presentation is only for information about the parts of the appliance.
Parts may vary according to the appliance model.

